

Panels: HDF/HDF

Facing: Outside 6,0 mm Tricoya
Inside 6,0 mm Tricoya

Core: Insulation - XPS

U-Value:

U-Value - W/m ² K				
	40 mm	45 mm		
	0,91	0,80		

Heat conductivity is calculated on the basis of the practical heat conductivity of each included material - taken from data sheets and DS418:2011

Weight:

Weight appr. Kg./m ²				
	40 mm	45 mm		
	9,68	9,85		

Size 1000 x 1000 mm.

Performance:

	Classification standards	Performance
Sound	EN 717-1	N/A
Fire	EN13501-1	N/A

Measure:

Min.: 120 x 250 mm - Max.: 1200 x 2400 mm

Tolerances:

Panel: Width/Height: +/- 1 mm - Diagonal: +/- 1,5 mm - Thickness: +/- 0,8 mm

Facing: Measurements on facing is before final sanding

Core: Inserts: +/- 1 mm on plywood

Section drawing:

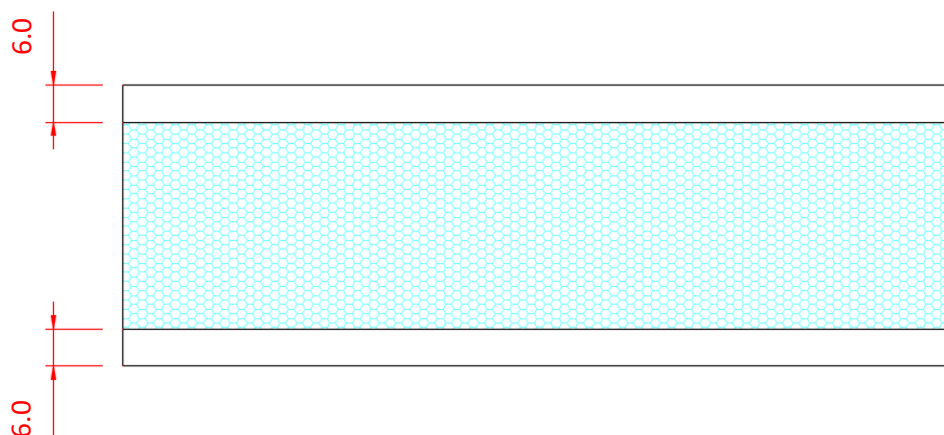

Made: 10.04.2025	Data sheet: OLN	Draw.: CRS
Revised:	Data sheet:	Draw.: